

Game of Life THE GAME OF LIFE MB. Milton Bradley



人生ゲーム キカアデー LOVELIFE

manual
operating instructions

Published March 2006

* Please read this instruction manual carefully and in a safe place after reading it.



You did it!!



includes Donchi 2 3 FC
1 CR2032 button battery for testing

homepage full of fun
<http://www.takaratoys.co.jp/>

*The illustration may slightly differ from the actual product.
Creation and writing TAKARA CO.,LTD. 2005

COMPETITION

Table of contents

- Table of contents... 1
- Things you should be aware of... 2
- Name and function...3
- Kisekai panel...4
- Turn on the power and have fun...5
- Gameplay
[Screen type]... 6
- How to play the life game Candy...7
 - [What happens when you run out of money?]... 8
- Introducing some of the Satoru child characters!...9
 - ★ Menu "Koudo"... 10
 - [Action Category No. 1]... 11
 - ★ Menu "Kochou"... 13
 - ★ Menu "Roulette"... 15
 - [Overview of the course]... 15
 - [Roulette: Love]... 17
 - [Roulette: Game group]... 19
 - [Roulette: Get item ⑧]... 19
 - [Roulette: Parameter UP]... 20
 - [Roulette: Parameter DOWN]... 20
 - [Roulette: Secret Shop]... 20
 - ★ Menu "Item"... 21
 - [What kind of items are there?]... 22
 - ★ Menu "Mail"... 23

Jinsei
Yamaari
Tanlari.



★ Menu "Tsuushin"... 25

- [How to use]... 25
- [Communication with mobile phone]... 27
- ★ Password... 28
- ★ Option... 29
 - [I don't like it]... 29
 - [Sound]... 29
 - [Gonchi Koukan]... 29
 - [Message speed]... 29
 - [Time change]... 29
 - [Contrast]... 29
- Reset... 30
 - All clear... 30
- How to replace the battery... 30
- Secret ending... 31
- Secret boy strategy... 33
- bonus "Masakiman Theater"... 35

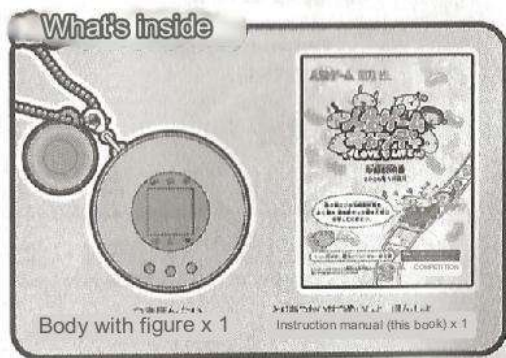

Hey, what do you want me to pay attention to?

Attention

For parents/guardians, please be sure to read this.

- There are small parts such as a button battery (CR2032). Never put it in your mouth. There is a sudden danger. • Please never give this to children under 3 years old as there is a risk of accidental ingestion.
- Button batteries (CR2032) are dangerous if swallowed. Please throw away the replaced button battery (CR2032) immediately. If swallowed, consult a doctor immediately.
- Parents should replace the button battery (CR2032). 《If batteries are used incorrectly, they may explode, explode, or leak. Please note the following》
 - Please set + (brass/minus) correctly.
- Do not short-circuit, charge, disassemble, heat, or put into fire. • If battery leaks into your eyes, immediately wash them with plenty of water and consult a doctor. When it gets on your face please wash with water.
- Do not wrap the ball chain around your fingers. It's dangerous because the blood doesn't flow.
- After playing, be sure to store it in a place where it cannot be touched by children under 3 years of age.

- (Precautions for use)
- Please read the "Instruction Manual" carefully before playing.
 - Product The transparent cover is a packaging material and should be discarded immediately after opening.
 - Constructed of precision electronic parts. Do not drop it, get it wet, get it dirty, or disassemble it.
 - Avoid using or storing in high temperatures or places subject to high temperatures.
 - Be sure to read the instruction manual when replacing the battery. Also, dispose of used batteries according to their own disposal procedures.
 - Please discard it. ○ The included button battery is for testing purposes only. If the screen becomes thin or the size of the cage becomes smaller, replace it with a new one.
 - The figures are coated with a bittering agent to prevent accidental ingestion. Wash your hands thoroughly after playing.



old and above
Target
age: 10
years

Do not splash water on the main unit or submerge it in water, as this may cause malfunction. Also, avoid using or storing it in humid places. please.

To customers
If you have any inquiries or concerns about our products, please contact us.
Please contact.
Publisher: Takara Co., Ltd.
Customer consultation center
3-39-6 Aoto, Katsushika-ku, Tokyo 125-0062 East
Beijing(03)3602-3030
1-17-14 Esakacho, Suita City, Osaka 564-0063
Saka(06)6339-6673



Please be careful

This product's strap hook hook is functionally so that the tip is...
Because they are laughing, it is dangerous to get your fingers caught. Intended use
Please be careful not to use it for any other purpose.

Please be careful



Name and work

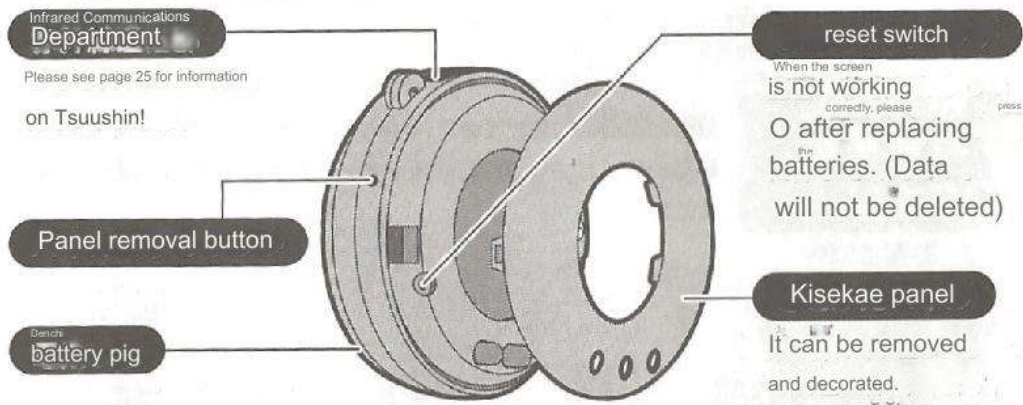
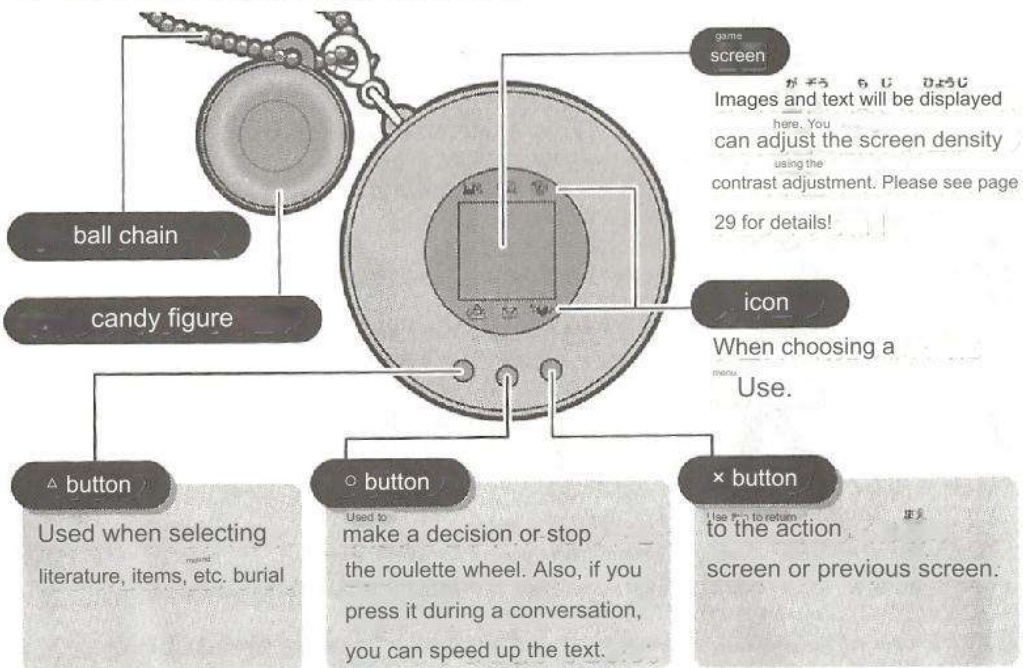

Auto power off function

Auto power off is a function that prevents unnecessary battery consumption. About 3 minutes and nothing The power will turn off automatically if you do not operate it. Also, turn on the power

③ If you want to do so, press one of the △○× buttons.

Kisekae panel

*Please do not play with the Kisekae panel removed!

<Removal ticket>

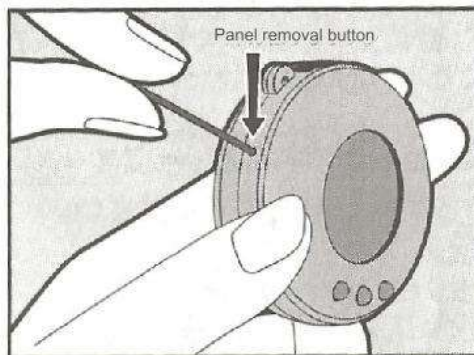

Press the panel release button with a pointed object (such as a toothpick).

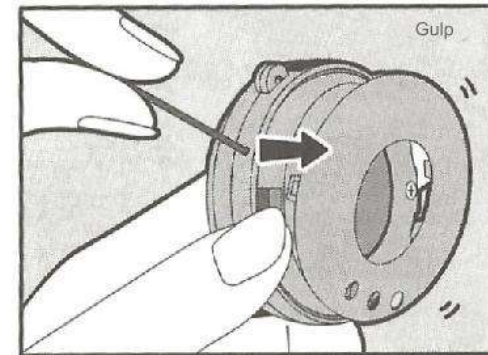

Press and hold the button and push the panel forward to remove it.

<How to attach>

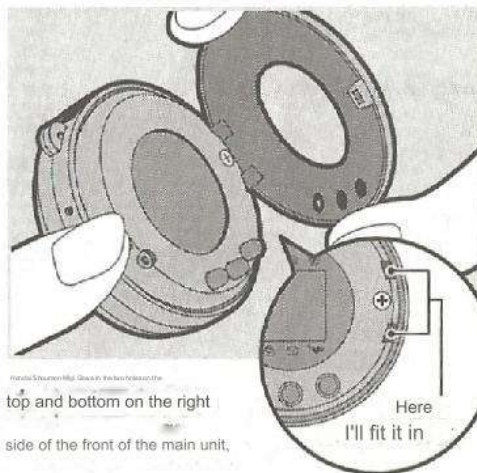

Attach the panel hooks firmly.

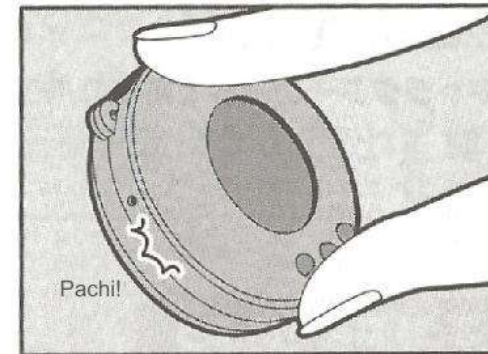

Be careful not to pinch your fingers, Press it onto the main body.

★ Turn on the power and let's play!

1. Pull out the insulation

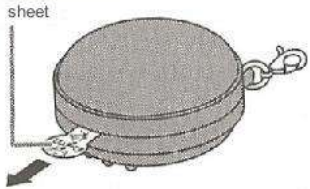

pull out the sheet that comes out of the main power. Discard the insulation sheet



opening movie plays, please complete all once before proceeding with the game.

clear all> Press the reset switch while holding down the x button. Please see page 30 for details!

2. Choose a character



choose your favorite character from the four types. Select with the Δ button and confirm with the ○ button.

initial parameters differ depending on the character!

rabbit	cat	mouse or rat	seiji
Smartness: 50	Cleverness: 800	Smartness: 60	Smartness: 800
Cuteness: 500	Cuteness: 0	Cuteness: 0	Cuteness: 800
Enthusiasm: 20	Humor: 10	Undo: 10	Undo: 0
Sense: 100	Sense: 10	Sense: 800	Sense: 500
Nikki: 100	Nikki: 50	Nikki: 100	Nikki: 100

3. Decide on the time



Let's set the current time. Press the Δ button to change the number. Masu. (Press for more than 1 second to feed the grass) Press the ○ button, Decide.

*You can change the options later.

Please see page 29 for the option "Time change"!

4. Decide on a name

Please choose a name.

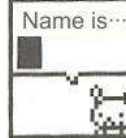
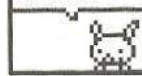

Give your character a name. You can enter up to 5 characters hiragana and symbols.

By pressing the Δ button, you can select from "A" to "Space". (Press the button for more than 1 second to move the grass forward.) Press the ○ button to select Literature. Press the x button to return to the previous selection.

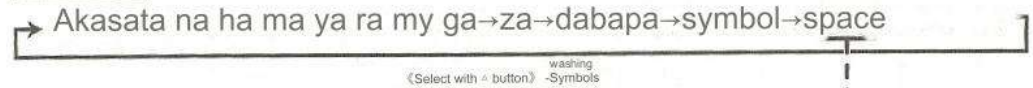

that can be done manually:



5. Determine your blood type



Press the Δ button to change the displayed blood type. Press the ○ button next to your blood type.

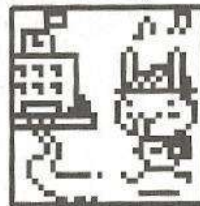

When an anime about entering elementary school is displayed

The game is starting!!

First of all, choose how to act as an elementary school student.

of game screen

Kodougamen action screen

My own character

What I'm doing now

Change

with the x button

Keigamen clock screen

Now the current time

I have Shobukuro's stage

*First time, I have \$500.

How to play life game candy

Let's experience life for a week!!

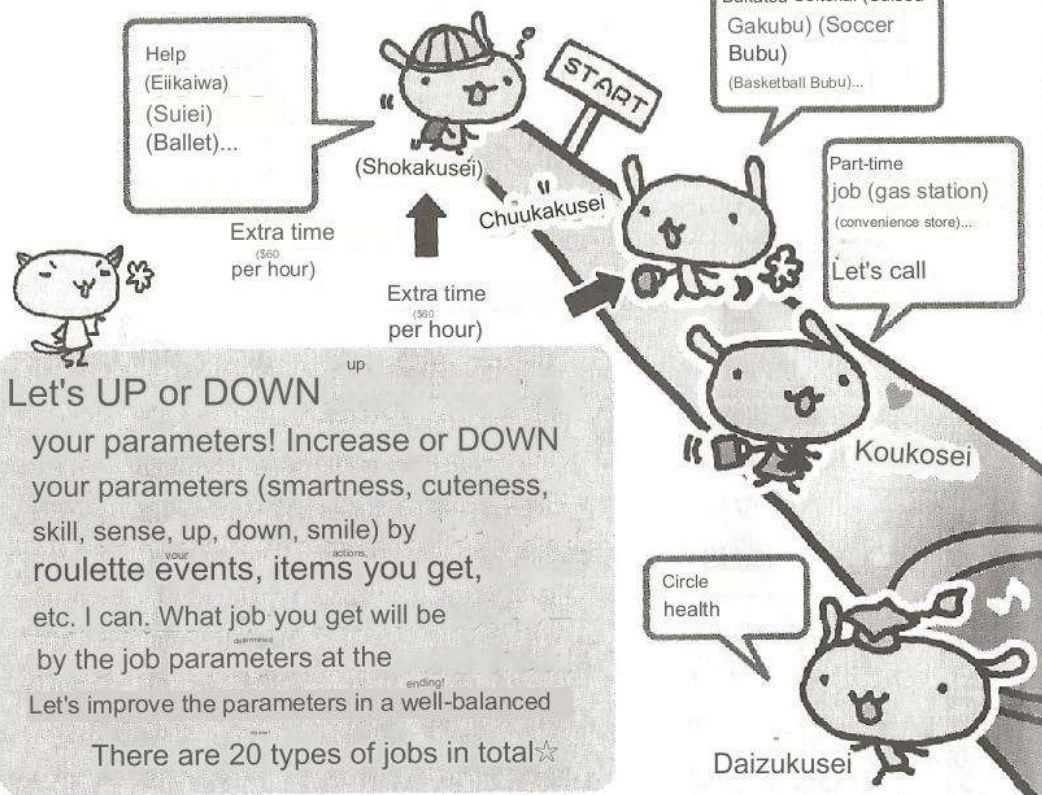

Let's UP or DOWN
 your parameters! Increase or DOWN your parameters (smartness, cuteness, skill, sense, up, down, smile) by roulette events, items you get, etc. I can. What job you get will be by the job parameters at the Let's improve the parameters in a well-balanced ending!
 There are 20 types of jobs in total☆

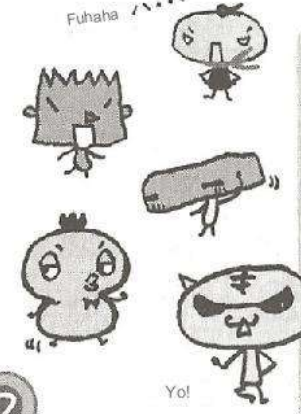

Man 2 with boys
 Over the course of a week, you will meet many different boys. Communicate with the boys you meet by going on dates or replying to them by email. If your love level reaches 4 or higher during the ending, you will receive a message saying, "Maybe that boy will make an exciting in uh
 There are 20 boys in all ♡
 For details, see pages 9, 32-34!

Raylet © Oh my god...!3
 You can spin the roulette wheel by paying \$60. Depending on the squares that stop, various events will occur, such as meeting a boy, getting items, and events that will increase or decrease your parameters.

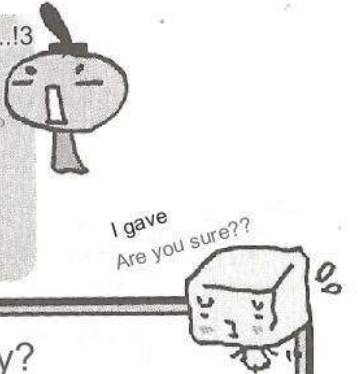

if you run out of money?
 You need money to spin the roulette wheel and win items. If you run out of money, first stop doing that cost money, such as "paraing," "juku," and "calling," and change them to activities that give you money, such as "helping" or "part-time work." You can also Kanemochi and turn it into money. *Elementary school and junior high school students will receive an allowance of \$60 per hour.
 You can receive

Circle Culture School
 What about work? What about love?
 marriage Please do it!
 Happy Wedding
 "When I started kicking, myself I received all my items."
 Children can play it ♡
Korir!!

Introducing some of the boy

for Shuta-kun, Sho-kun, and Masakiman is on pages 33 and 34 ☆ Check it out!!

Mitsuo-kun

Pure-hearted and naturally loving.

出会い: 満足



Tsuyoshi-kun

Chibisuke wearing Ochoshi clothes.

Encounter: Sports Day



Takashi-kun

A guitarist who loves singing.

Encounter: Choral Contest



Osamu-kun

I can't do anything

without mom...?

Encounter: Training camp



Hiroyuki-kun

10 I love

cooking. School trip (



Yoshitaka-kun

A playful modern child.

Encounter: Group date



Kosuke-kun is a

passionate Kansai person.

Encounter: School festival

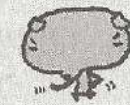

Shuta-kun

I like the game, I like it

Unbearable. dating con



Shigeo-kun

For some reason it seems like an error.

Selfish. Encounter: Company trip



Mr GG

Romantic Nasami

Shigariya. Interested in space!

Encounter: Love event



Sho-kun

A Yankee who can't get used to it.

Encounter: Love event



Kiyomaro

I love peace very much.

Encounter: Love event



Michael

Nippon Daiski

A gentleman born in America.

Encounter: Love event



Kenichi-kun

A mysterious prince.

Encounter: Love event



Akira-kun

A refreshing and popular guy.

Encounter: Love event

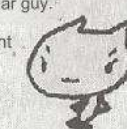

Masakiman

A hero of justice. Evil

organization "Piratesumi"

"Monkey" is fighting. Self

Encounter: Love event



Other wonderful things

the boys

What should I do?

I'm looking forward to it!~(^_^)

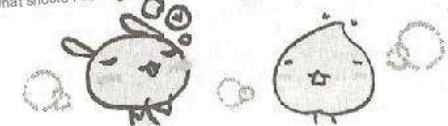

Menu "Koudo"

You can change character does here.

now

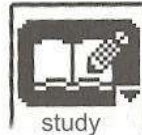

Decide what action to take now. Select an action using the Δ button, then press the \circ button to confirm. The selected action will now be performed on the action screen.

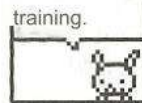

"Bukatsu/Seitokai", "Part-time job", "Circle", and Naka are selected from several options.

You can only select these actions once per stage!

For example, if you are a junior high school student and select "Basketball" Seitokai", you will not be able to select other "Bukatsu" until you become a high school student.

Mokuhyo

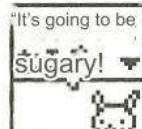

If you are unable to perform the action you had chosen due to character growth or lack of money, decide on an alternative action. Select an action using the Δ button, then press the \circ button to confirm.



"I'm going to become a sugar beet!" → Kashikosabi P "I'm going to be fashionable!" → Sense UP "I'm going to be cute!" → Kawaiisabia "I'm going to be healthy!" → Health UP "I'm going to be healthy!" → Undo UP "I'll be lazy..." → Nothing

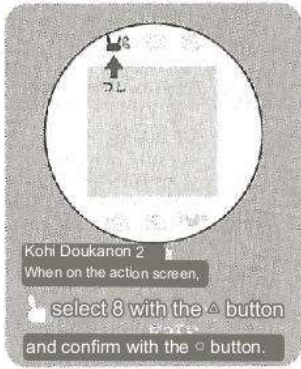

25 47 10 30 03 51
List of action types

If you continue doing the same action for 10 minutes, the parameters will change and you will be able to move forward. Changes made within 10 minutes will be invalid. Parameters not written here will not change.)

*... This is an action that appears when a certain task is

(◎)...It's an action that follows money. If you run out of money, you won't be able to act.



^{Zen}
Training (all stages)
Smartness 50↑



HELLO
Nairai goto
(Elementary School)
Money \$20↓
Smartness 100↑
Nikki 20↑



high school
Money \$60↓
Smartness 200↑



^{Zen}
Fashionable (all stages)
Cuteness 50↑



Trait and Shogakko Ballet
(Elementary School)
Money \$20↓
cuteness 100↑
Nikki 20↑



Bukatsu
(Junior High School/High School)
Cuteness 100↑
Smartness 50↓



^{Sen}
Kintore (all stages)
Undo 50↑



Training school school
(elementary school)
Money \$20↓
Undo 100↑
Nikki 20↑



Basketball (Junior High School/High School)
Undo 100↑
Smartness 50↓



^{Zen}
Drawing (all stages)
Sense 50↑



Trait and school piano
(elementary school)
Money \$20↓
Sense 100↑
Nikki 20↑



Fukatsu
Suiso Gakubu (Junior High School/High School)
Cuteness 30↑
Sense 40↑
Ginki 30↑
Smartness 50↓



^{Sen}
Chatting (all stages)
Nikki 50↑



School help
(elementary school)
Money \$20↑



Bukatsu
(Junior High School/High School)
Sense 100↑
Smartness 50↓



time (all stages)
Nothing

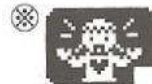

Koyaku (Elementary School)
Money \$100↑
Nikki 50↑
Smartness 100↓



Soccer Bu (Junior High School/High School)
Cuteness 40↑
Undo 30↑
Ginki 30↑
Smartness 50↓

Elementary school and high school students can receive an allowance of \$60 per hour!

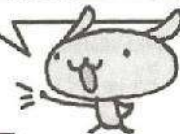

Seitokai (junior high school/high school)
Nikki 100↑
Smartness 50↓



Part-time job Zasshi model (high school/teaching)
Money \$100↑
Cuteness 50↑
Sense 20↑
Nikki 20↑



Circle Daigaku Shakaijin Band (University/Worker)
Sense 50↑
Nikki 50↑
Smartness 50↓



Kiaiyopikou (High School)
Money \$60↓
Smartness 200↑



Waitress (School/Funny)
Money \$100↑
Cuteness 20↑
Undo 20↑



Circle Daigaku Dance (University/Worker)
Sense 100↑
Smartness 50↓



Yaki Yobikou (High School)
Money \$200↓
Smartness 600↑



Part-time job shop tenin (high school/dropout of school)
Money \$100↑
Sense 20↑
Nikki 20↑



oryoriyoshitsu (working adult)
Money \$100↓
Cuteness 20↑
Sense 100↑



Hissho Yobikou (High School)
Money \$60↓
Smartness 300↑
Cuteness 50↓
Undo 50↓
Sense 50↓
Nikki 50↓



Gas station (Sagiryō/Tsugaku)
money \$100↑
Cuteness 20↑
Undo 20↑



Design school (working adults)
Money \$100↓
Smartness 100↑
Sense 20↑

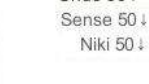

Convenience store (Kuryō/)
Money \$100↑
Smartness 20↑
Undou 20↑



Circle Daigaku, Shakaijin Tennis (university/working adults)
Undo 100↑
Smartness 50↓



Gym (Working Adult)
Money \$100↓
Undo 100↑
Nikki 20↑

Menu "Techo"

You can check your own parameters, information about moms, current status and relationships, jobs you've had so far, and boys you've married.

myself

can also check your parameters. After the parameter graph is displayed, press the \circ button. Each time you press it, the parameter values of smartness & cuteness, kindness & sense, and cheerfulness are displayed in

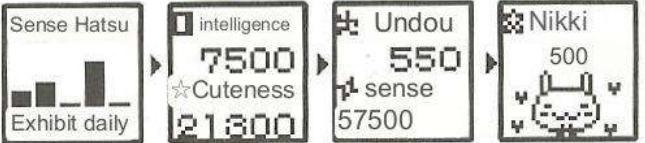

Man This child can be registered up to 5 people.

want to see

If you select it with the Δ button, you can see the love level, future work (\times), and future plans.

Koikoujyou
You can watch it if you are a high school student or above.

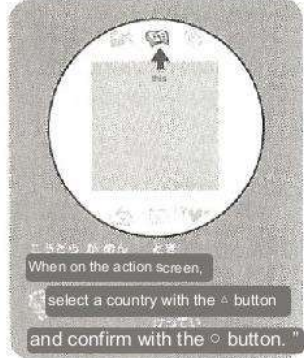

I want to forget

I'll take care of the boy I chose. You can erase it from Also, subsequent generations also forget that they were married in the past. (\times)

...The achievement rate will also decrease.



Friends

up to 3 friends on the Friend Network. See page 27 for information about friends.

want to see

You can see your friend's character and level when they meet. Press the Δ button to see other friends.

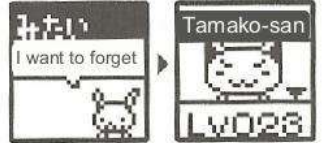

I want to forget

If you select it with the Δ button and press the \circ button, you can erase the following from your hand.



*If you register friends with a high level, you will get a good thing... \heartsuit

Family

You can see the work of moms, dads, grandmas and grandpas.

Arata (does)
not appear when playing for the first time/if parents are not present

mom
charismatic beauty



see mom's name and job. You can also see family members by pressing the Δ button. you can view a commemorative photo of the family at work.

Remember

You can see the completion rate of boys, tasks, and items. It will not appear



love after all clears
You can see LOVE and work completion rate. Press the \circ button.

LOVE

"Job", or "Mochimono". Select with the Δ button and confirm with the \circ button. When each item is displayed, press the Δ button to see all the boys you have married, the jobs you have had, and the items you have obtained.



Menu "Roulette"

can spin the roulette wheel by paying \$60. Press the button to stop the arrow. You can move forward by the number indicated by the arrow.



Zentaizu

《Overview of the course》

starting position

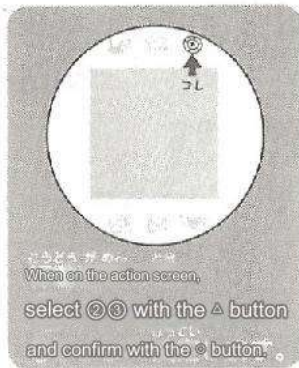

GA ME								
	A new encounter with a boy... Tomodachini		Changing parameters up in the game					
GA ME								

•Roulette square name

- () ... Lovemas
- () ... Parameter UP square
- () ... Gamemas
- () ... Parameter DOWN square
- () ... Item get mass
- () ... Secret shop mass

GA ME								
	being stalked Undo down!		being watched					GA ME
	packed Go to a beauty salon and increase your cuteness!		Cupine!!					
GA ME								
GA ME								
GA ME								

Caution>>If the auto power turns off during a roulette event, the event will end.

Also, the effects of parameters and love levels caused by the event may not be reflected.

"Roulette" love ♡

This is the square where a love event with a boy will occur!!

we met



You'll meet a lot of boys~♡♡
If you accept a boy's invitation to a date, you can register him as a Techo!

When a boy appears, he will ask you out on a date. using the Δ button. The boy you date will be registered on Techou Touroku, and you will receive emails and gifts from him.



attack



Give presents and souvenirs to the boy who wrote on the tip!
Increase your love level with a love attack!!

After confirming what kind of attack he will use, press the Δ button. If the boy expresses his feelings, the level of love will increase.



date



Date a boy. Depending on where you go, the parameters will increase a little. The boy will tell you if you listen carefully, you will be able to find out what use this as a reference when replying to emails later.

a date with a boy who is registered on Techou. Select the place you want to go on a date with the Δ button and confirm with the \circ button. During the date, the boy will talk to you about various things. To reply to a conversation with a boy, press the Δ button to select and press the \circ button to

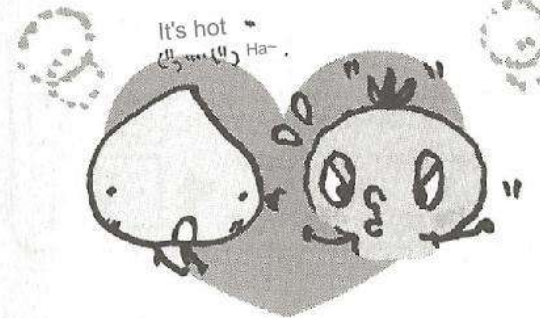
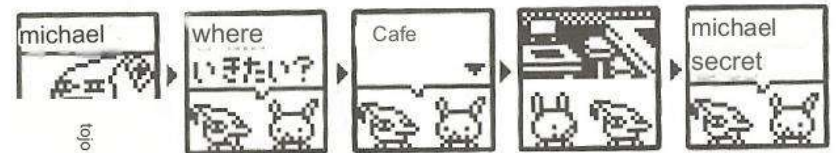

"Roulette" game



Use the crane to pick up the icon that
increases the parameters.
 If you fail once, the game will end!

□: Smartness +300UP : Undo +300UP: Sense +300UP
 ☆Cuteness +300P : Ninki +300UP : All +300UP

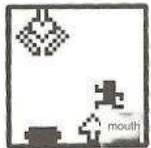

The icon that appears varies depending on the time.



Move the crane with the button and align it perfectly with the center...



When you press the button, the crane lowers and catches the icon!



If you get it right, set the parameters **UP!**

Get "Roulette" item



You can get items by receiving or picking up items from boys and moms (*2nd generation only)! Boys with a high level of love will give you good presents, so do your best to increase your level of love.

For example, in the case of Mitsuo-kun



"Roulette" parameters UP +

An event occurs that causes the parameter to go up. The parameters to be UP vary depending on the event.

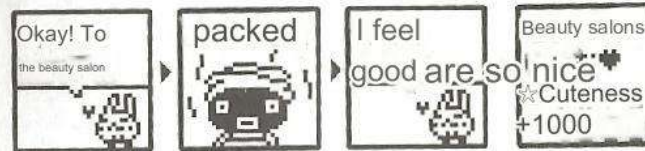

*"Roulette" parameters DOWN



An event occurs that causes the parameter to go down. event parameters vary depending on the event.

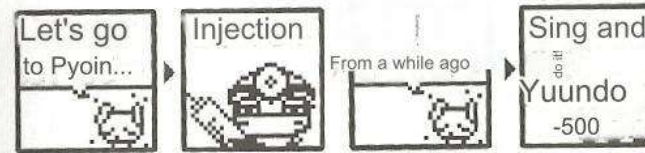

"Roulette" secret shop?

can buy items that aren't sold at normal Omise! The store clerk, Tatsuo, is secretly running the store for the boys.



Items can be purchased at the same rate as in the shop "Okaimono" mode.

*Please see page 21 for details on the item "Okaimono" mode!

Ah!
 It's a present from Michael!

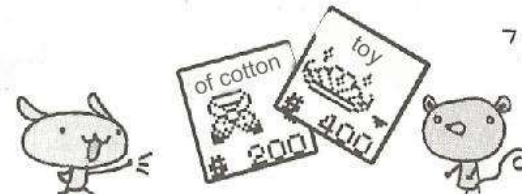

7474...
 This is this price

So...

item

You can make food and check the items you currently have. The parameters of will increase just by UPing it.

(some items do not affect parameters)

food



and sell items at the store run by Keieika Tatsuo. The selection changes depending on your growth, so check back every day!

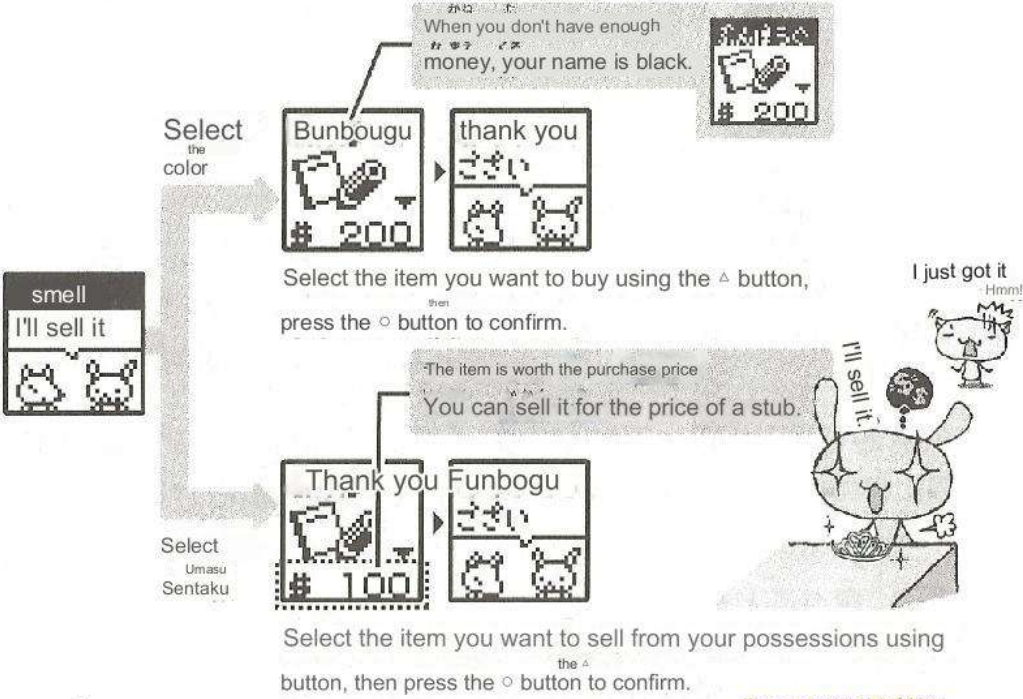
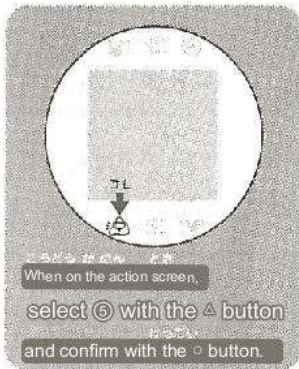

Welcome! Tatsuo-san

Although he is young, he is an eccentric and talented man who owns his own shop.

With a friendly personality, everyone's fire starter!

Wonderful...

You can carry up to 10 sticky items!

Dream, you can see the items you own. When the items are full, let's go to Tatsuo's shop to sell them!

You can see the item's name, image, and selling price. Press the button to see other items. By pressing the button, you can see the name and value of the parameter that increases when you have that item.

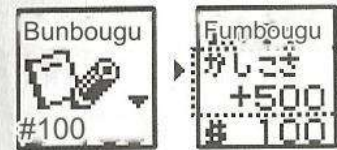

If the item is not affected by parameters, will be displayed here.

are some jobs that you can't do unless you have certain items

《What kind of items are there?》

types of items!

There are items that increase your parameters just by them, and rare items that do mysterious things just by holding them.

《Rare item introduction》

can get it, you'll be very

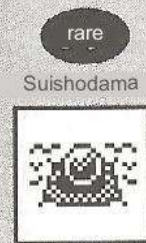

If you have it, the number of squares will increase.



depending on the



Tatsuo's shop

25% off items
You can shop at Gamono. become

Menu "Mail"

You will receive emails from boys, mothers, and friends who have registered with "Kocho." When an email, the will flash, so if you find it, check it immediately!

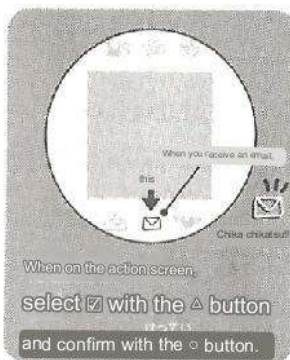

When an email is received, flashes. Enter the menu "Mail" Yes, select the email you want to read using the button, and press the button to confirm.



[Email from Isamu's child]

It's an envelope with a heart sticker on it!



[Email from a friend] It's

an envelope with a star sticker on it!



[Email from Mom] It's

an envelope with a flower sticker on it!

You will never receive more than one email from one person at the same time!

When flashes, check/reply immediately and wait for the next email.

You cannot reply to emails from friends or mom.

If you forget a boy in Techo, that boy's mail will automatically disappear.



Mail from a boy

You will receive an email from a boy who has registered with Techo. To reply to the email sent by the boy, press the button to select a reply, and press the button to confirm. Depending on your reply, your love level with the boy will increase or decrease.



Email from friend

and register your friends as a friend, you will start receiving emails from them. Sometimes they will send you emails that will help meet a nice guy. *Please see page

25 for information on the service!



(Encouragement email)



(Maybe with a nice boy?!)



email from mom

mother is around, she sends me encouraging emails.



Mom~...!

I'm doing my best~(^-^)

Menu "Tsuushin"

You can buy and sell items with friends and register friends ♡

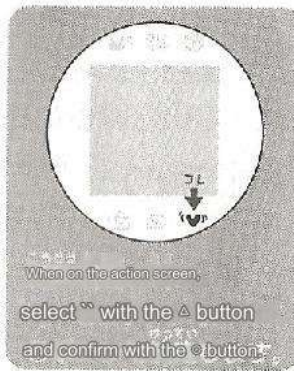

How to make money

The receiving side

Press the button and wait*

Sending side

When you're ready, press the kick button!

the \circ button. Press the \circ button

20 degrees
20 degrees
20 degrees
20 degrees

Within not present

Please keep the height of communication parts of each other horizontal, and do so within a distance of 20 cm and within 20 degrees to the left and right. *Communication may not be possible under

*Communication may not be possible near lighting that emits strong infrared rays.

You can buy and sell items with friends and mobile phones.

Friends 3

The flowchart shows the following steps:

- Player 1 (left) selects an item (e.g., Bunbogu #100) and presses the button, saying "Wait".
- Player 2 (right) selects "Uru" (buy) and presses the button.
- Player 1 presses the button, and Player 2 presses the button.
- Information is exchanged between the two players.
- Player 1 receives the item and says "It was nice!".
- Player 2 receives money and says "I'm so happy~".
- Player 1 says "I'm running out of money. Get the item!!".
- Player 2 says "Item is missing. Get money!!".

your friend Ren's data.

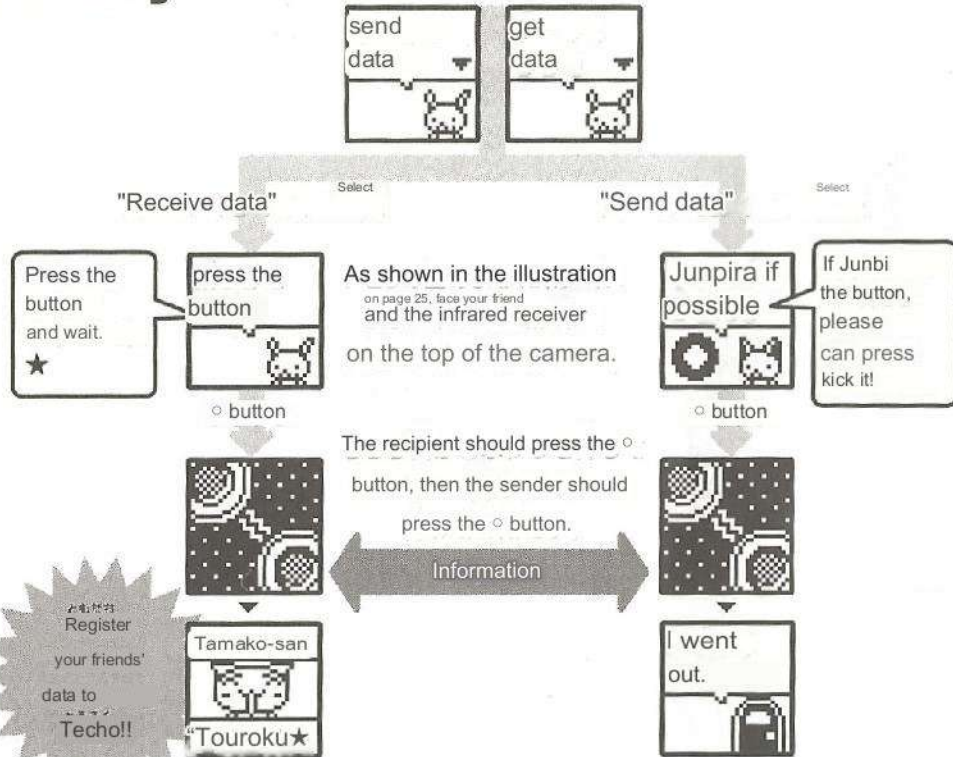

with mobile

You can communicate with the Life Game Candy body using your mobile phone!

Select "Mochimono" as "Kau" in "Transfer" and press the button to display the communication screen.

Then select the "Send" button on your mobile phone. Detailed communication methods and compatible models is Life Game Candy's mobile phone site or Life Game on Takara's HP.

Check out the candy site!

*This service may be relocated or terminated due to various circumstances. If you wish to terminate, please notify Takara at least 3 months in advance. It will be posted on the Life Game Candy site on the website.

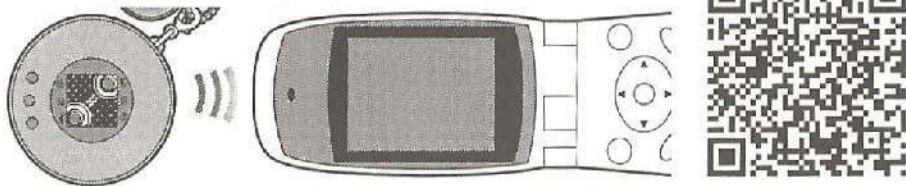

password

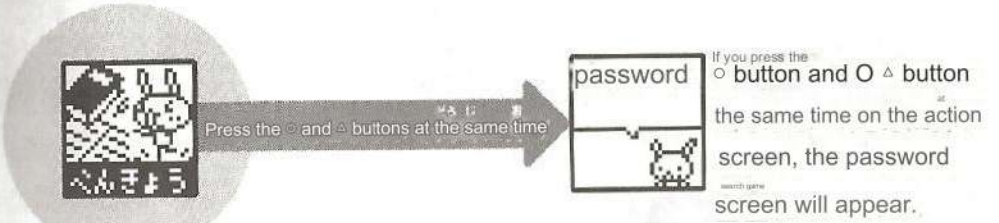

the password you got from the Life Game Candy HP what happens when you enter your password!

Enter the password you obtained carefully. Use the button to enter up to 5 characters from "a" to "space" and press the button to confirm. The operating procedures and characters that can be entered are the same as for entering a name.

Game Candy Official Homepage

<http://www.takaratoys.co.jp/jinsei-candy/>

It's full of fun information such as 4- and character introductions



option



Press the ○ and × buttons at the same time.



If you press the ○ button and the × button at the same time on the action screen, it becomes an option.



I don't like it

By spinning the roulette wheel, you can predict today's fortune and lucky items.



sound

You can take out or remove clothes. Select with the △ button and confirm with the ○ button.



Denchi Koukan

If you turn off the power and replace the battery at this point, you can change the battery to a new one without forgetting your data. If the Denchi Koukan screen turns off, replace the battery.

Please see page 30 for instructions on how to replace the battery.



message speed

You can change the speed at which literature is displayed in three stages. Select with the △ button and confirm with the ○ button.



Time change

You can change the time. *See page 5 for time settings!

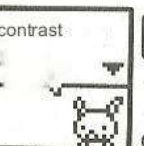

contrast

You can adjust the screen density. Adjust with the △ button and confirm with the ○ button.

reset data will not be deleted!!

or if the screen is not working properly, press the switch with a toothpick,

All clear

etc. *All saved data will be deleted.

*Please be careful!!

Use this when you want to erase all saved data when starting the game the first time. Press the reset switch while pressing the × button.

How to replace the battery

- ① Prepare a new CR2032 button battery, a screwdriver, and object (such as a toothpick).
- ② Use a sharp object to remove the panel. burial Please see P4 for details.
- ③ Option "Denchi Kokan" off the screen.

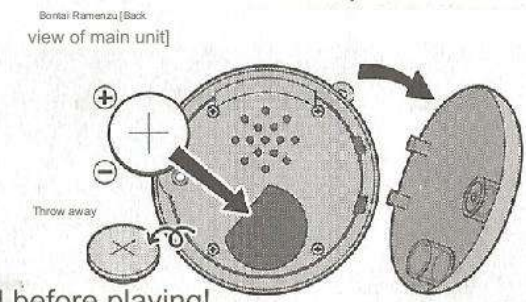
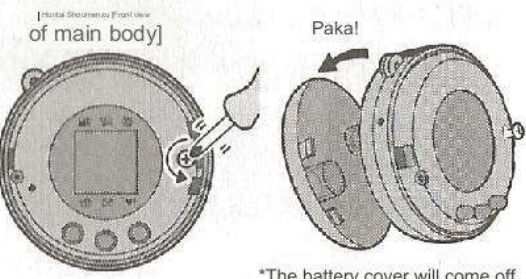
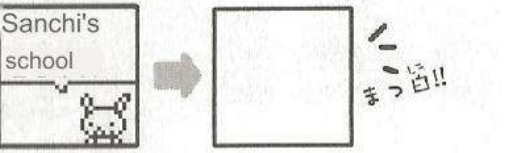
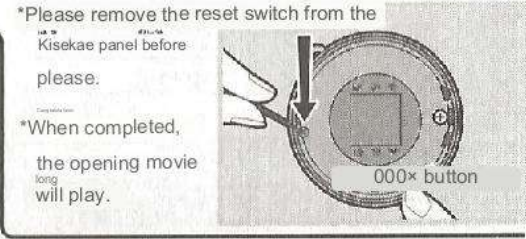

old battery, insert a new one within 30 seconds, close the battery cover, and press the reset switch. When the action screen appears, the exchange is complete.

*Be sure to attach the Kisekae panel before playing!
Please do not put anything inside Hanaike Puta. There is a risk of short circuit. 39

⑦ Ending

I'm looking forward to seeing what it will become~



Here is the result of your life for one week!!

job did you get?! Will a boy propose to you?!

It will be revealed in this ending.

Work

Isha



balance of parameters at the ending will determine what kind of job you will get.

There are 20 types of jobs in total!

- How to become a "doctor"...?
→ Smartness 70000 or more



- How to become a "patisier"...?
10,000 or more, sense 20,000 or more



- How to become a "musician"...?
→Cuteness 10,000 or more, sense 10,000 or more, smile 10,000 or more



*If the overall parameters are satisfied, you may be assigned a different job.

There are many other jobs!!



If there is a boy with a love level of 4 or more...

LOVE



the end of Hanamake,

If you meet a boy with a love rating of 4 or more, he will propose to you! However, men's hearts may be

fickle... Let's raise the level of love to the fullest and make it lovey-dovey!

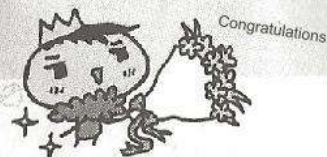

Even more!!

A child was born! If a boy proposes to you, you will get married and have a child. You can proceed with the second generation game using the character machine.



- ★All items owned by parents can be inherited by children.
- ★Money/parameters will return first.
- ★Your friends' data will be lost.

When no one proposes...

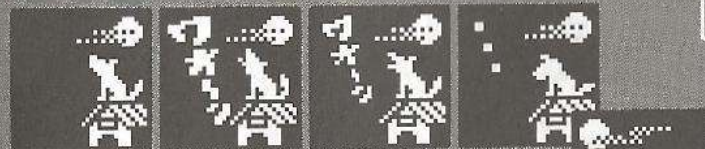

Ending alone...

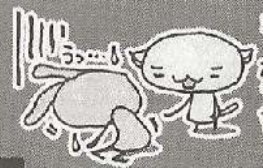

Good luck next time!!

I'll tell you a little bit about how to conquer the boys who appear in Tojo Otoko Koryaku Houhou!

For "beginners" Sho-kun



They tend to appear in the first half of the game, romance with them over time.

to conversation and email on a date is to person's personality. "I can't become Sunao."

The point is, "Actually, he's a bad guy."

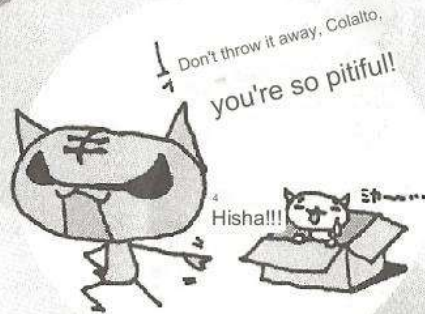

for "intermediate" players



A rare character that meet at a group party right after

entering the workforce.

whether you want to go to university or the workforce, you will miss out on many to meet new people.

If you meet someone, register with Otokoko Leave the boy alone with make love and increase your love level!

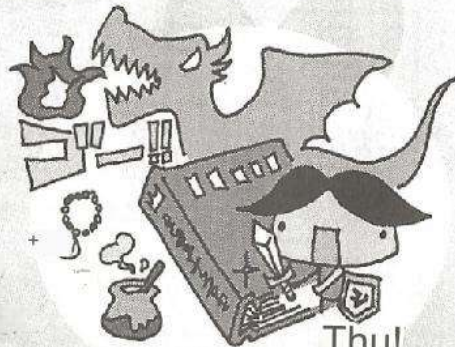

I really like drabs.



I see..... A minded person creates love!

Tou!!



Masakiman & Masakikun for advanced users

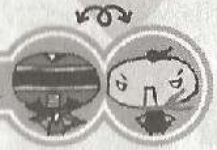

who fights against the evil organization "Pirate Monkey", and identity, Masaki-kun.

If you increase the LOVE level of Masakiman only, you will end up marrying a pirate monkey wearing Masakiman's

marrying Masaki-kun's pirate monkey, you must first send Masaki-kun away. Be the first to register and set your love level to ♥♥♥♥♥♥. I would that time!! If you have a certain item that will give you a present, you will be able to meet Masaki-kun, and in order to If you increase your love level, Masaki-kun, the real Masakiman, will propose to you. At



strategy book that will help you understand everything about this game, "Game of Life Candy and PlayBook" is now on sale from Enterbrain!!

For more information, please visit <http://www.enterbrain.co.jp/34>



Gekijo



Bonus "Masakimanpa" 場



Masakiman

Do it! ~!! World peace

I love you very much

Everyone's hero!

VS

キリッ!!

There are many more.



pirate monkey

An evil organization. Hiro engages in with Masakiman every

day!!! "Yes" is all he can say.



Masakiman in battle!!!



A little moment between battles. A suspicious Aya Kage...



3. Your mask may be stolen! Good luck Masakiman!!

Farewell!!!!



Bou ♥ Masakiman's strategy is on D34 ♥

